

# SURVIVOR 2



**ASKING PRICE: € 10,500,000 VAT PAID**

based Marseille





# SURVIVOR 2

Year built: 2017





# SURVIVOR 2

Year built: 2017





# SURVIVOR 2

Year built: 2017







# SURVIVOR 2

Year built: 2017





# SURVIVOR 2

Year built: 2017







# SURVIVOR 2

Year built: 2017







# SURVIVOR 2

Year built: 2017





# SURVIVOR 2

Year built: 2017







**SURVIVER**

# SURVIVOR 2

Year built: 2017

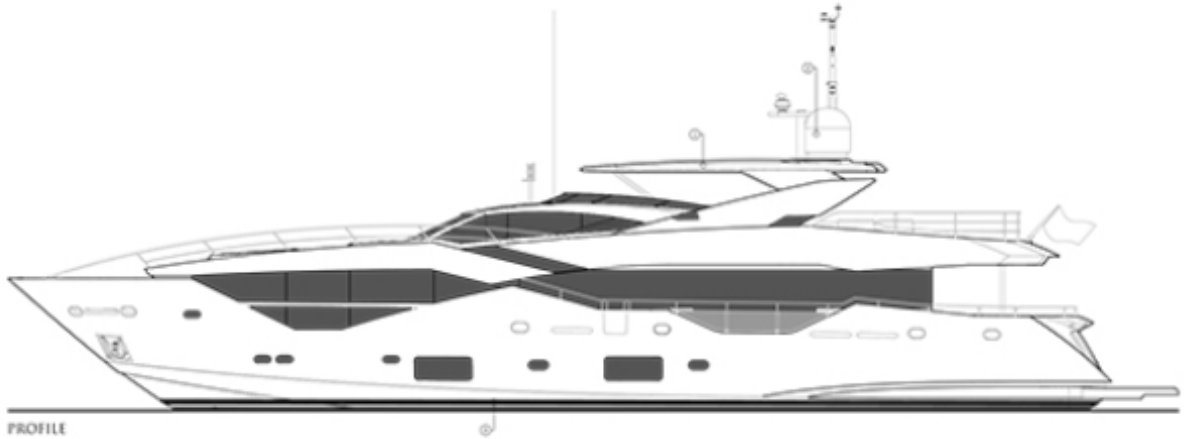

PROFILE

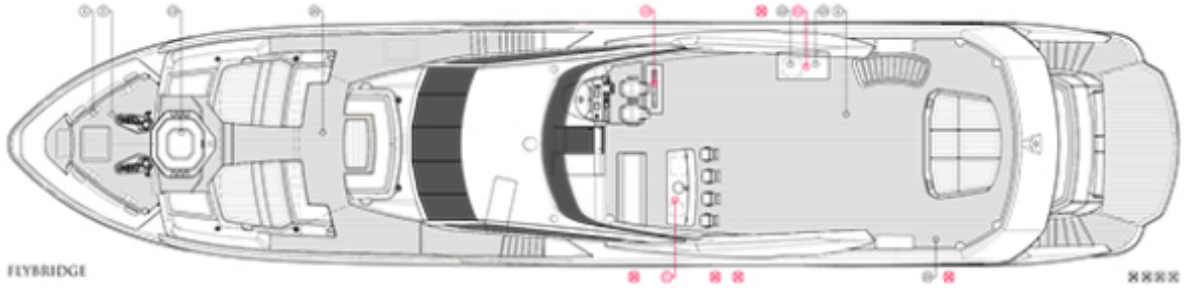

FLYBRIDGE

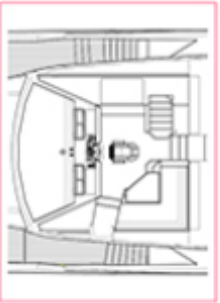

WHEELHOUSE

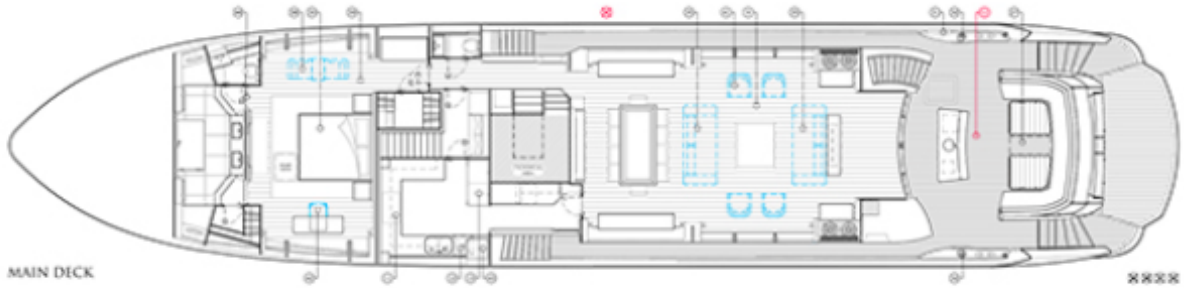

MAIN DECK

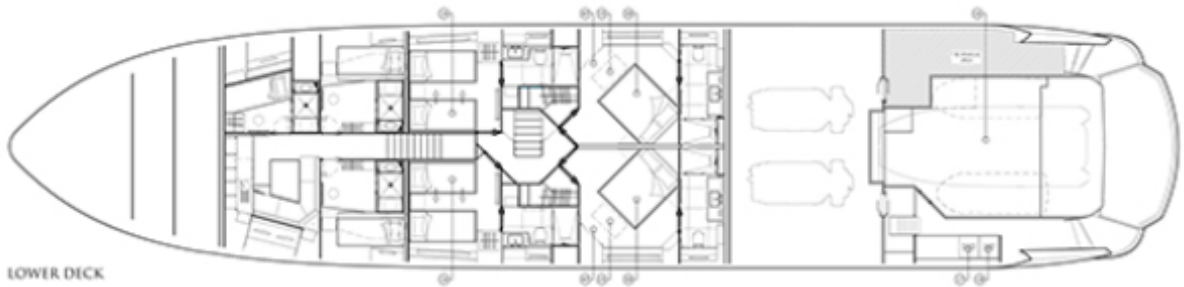

LOWER DECK

# **SURVIVOR 2**

Year built: 2017

---

## **Description**

The Survivor 2, measuring 35.2 meters in length and 7.33 meters in width, is a luxury yacht made of fiberglass/GRP. Powered by 2 x MTU engines (2,640 hp each), it can cruise at a speed of 19 knots and reach a maximum speed of 25 knots, offering a cruising range of 1,250 nautical miles and a total range of 2,000 nautical miles. The vessel can accommodate 10 guests in 5 luxurious cabins and is equipped with 2 Kohler generators (70kW each) to ensure reliable electrical power. The Survivor 2 offers an exceptional sea experience, combining elegance and cutting-edge performance.

## **About the boat**

Step into a world of timeless elegance and modern design as you board the Survivor 2.

This yacht is bathed in natural light, creating an inviting and stylish atmosphere throughout. The interior decor is a testament to contemporary sophistication, featuring a tasteful color palette and premium materials that offer both comfort and refinement.

At the front of the yacht, a Jacuzzi awaits, providing the perfect spot to unwind while taking in stunning panoramic views.

The spacious interior ensures you have plenty of room to relax, socialize, and enjoy your journey.

From the comfortable cabins to the stylish communal areas, every inch of the Survivor 2 has been designed with your comfort and enjoyment in mind.

In short, the Survivor 2 is the epitome of luxury, offering a bright and modern interior, a front-deck Jacuzzi with a view, and ample space to make the most of your journey on the water.

# SURVIVOR 2

Year built: 2017

## MAIN FEATURES:

Builder:	Sunseeker International	Length:	35.2m / 115' 6"
Year:	2017	Beam:	7.33m / 24' 1"
Engines:	MTU 16V 2000 M96L 2640hp	Draft:	2.39m / 7' 10"
Speed:	25 knots	Accommodation:	10 Guests + 5 Crew
Boat Ref:	SM-5127	Location:	Marseille

## ADDITIONAL EXTRAS

- › Platinum Upgrade Package (Includes the following options):
  - › Upgraded Anchor chain,
  - › Second pair of Mooring Bollards on Forepeak,
  - › Stainless steel Hydraulic Passerella upgrade,
  - › Side mount stairway,
  - › Teak Decking on Forepeak,
  - › Teak Decking on Flybridge,
  - › Antifouling Application upgrade,
  - › Trailing Pumps,
  - › Auto Troll for Transmissions,
  - › Hydraulic Sleipner Stern thruster system,
  - › Fin stabilization system,
  - › Sewage Treatment plant,
  - › Air Conditioning for the Engine Room,
  - › Air Conditioning Marine Air chilled water system to Tropical specification and with quieter running WhisperCool DC fans,
  - › Diesel fuel long range overload tank of 5,050 litre capacity,
- › Alfa Laval Fuel cleaning centrifugal separator,
- › Two Kohler 70kW in lieu of 55kW,
- › Tjssens CCTV camera system with eight dedicated cameras,
- › Tjssens SMS Paging facility,
- › Tjssens Swipe card security alarm Integrated to MPA system,
- › Tjssens MPA Generator Control and Monitoring System Upgrade,
- › Vimar ByMe Interior Premium Lighting System Package,
- › Superyacht Custom Commercial Galley Refrigeration,
- › Miele Professional Appliances upgrade - Miele Washing machine, Miele Tumble dryer and Miele dishwasher,
- › Flybridge hardtop, including retractable centre canopy and aft extending sun canopy,
- › Underwater lights x 15.
- ›



- › Built to RINA commercial rules 2013 and conformance to MCA LY3 but only issued with RINA pleasure certificates and MCA LY3 statement of compliance (private registration)
- › Interior Wood Finish - Wenge Gloss Finish
- › Medium Tinted film to side windows and sliding doors
- › Sprung mattress for Crew beds
- › Inboard berth moves outboard to create double berth - Forward Stbd & Port Twin Cabin
- › Black out Blinds for the Port Aft Guest Stateroom, the Starboard Aft Guest Stateroom, the Port Forward Guest Stateroom and the Starboard Forward Guest Stateroom.
- › Anchor windlass gypsys upgraded for 16mm chain. Two 165 metre lengths of 16mm high tensile galvanised chain.
- › Second set of stainless steel bathing ladder sockets on the aft face of the Bathing Platform
- › Carbon fibre and polished stainless steel ensign staff suitable for 2.5 yard ensign
- › Octo Marine Compact Water Softener
- › Water Maker - Idromar Water Maker 250 litres per hour (MC5S-250A-2) 380V 50Hz - Three Phase
- › Bidet option for Tecma toilet in the Master En suite Toilet
- › Tender diesel fuelling station with transfer pump from day tank and fuel hose reel
- › Portable air compressor OP20P stored in the engine room with AC 220v power supply sockets in Garage, Engine Room and Fore Deck.
- › Kahlenberg signal timer option on lower console
- › Iridium 9555 Satellite Phone system with docking station and external passive antenna.
- › Electronic Chart System upgrades. Transas AIS, ARPA and Radar intergration.
- › Navigation Equipment Upgrade for LY3:
- › Measuring Log and Echo Sounder. Furuno LS6100 with console and crew mess repeater RD33.
- › GPS. Furuno GP170 GPS Navigator with GPS antenna.
- › AIS. Furuno FA150 Class A AIS Transponder with GPS and VHF antenna.
- › Bridge Navigational Watch Alarm. Furuno BR500. › Rudder Angle Indicator. Simrad RF45X.
- › Satellite Gyro Compass. Hemisphere GNSS V103. › Autopilot. Simrad AP70.
- › Magnetic Compass. A magnetic compass with 6" card.
- › Central Navigation Display. FT Nav-vision Navigation data display with trackball and wireless keyboard.
- › Communication Equipment Upgrade:
- › MF Radio. Sailor 6310 MF/HF 150W Radio Telephone.
- › VHF Radio. Sailor 6222 Class A VHF - DSc.
- › VHF Radio. Simrad RS90 Class D VHF/DSc with Handsets in Wheelhouse, Fly console, Crew Mess and Emergency Steering Position.
- › Inmarsat C with LRIT. Sailor 6110.
- › Navtex Receiver. Furuno NX700B.
- › Handheld Portable VHF's. 2x Icom IC GM1600E and BP234.
- › EPIRB. McMurdo E5.
- › SART. McMurdo S4.
- › Furuno ultra sonic wind sensor connected to the Central Navigation Display.
- › Bang & Olufsen audio visual upgrade as detailed in each guest area except Wheelhouse, Crew Mess and Crew Cabins.
- › Prep only for future fit of Chandelier above the dining table (see spec for fitting details)
- › Satellite Television System. Seatel 100 TVHD 3 Axis Global including 3 x Technomate Euro free to air HD decoders. Saloon, Master Stateroom and Crew Mess. Crew Mess decoder to be fed also to the Captains Cabin television with local control.
- › Pre wire for possible future installation of satellite communications (Sea Tel V Sat)
- › 2 x charging points in the garage (sockets suitable for garage space)

- › **Wooden flooring Cadorin Wenge WENSP0P10 in the Main Deck Saloon, Dining and Starboard Side Entrance Lobby (Note: the flooring is to be continuous with no recesses for carpet)**
- › **Pre wire for back lit signwriting on the stern**
- › **Exterior overhead lighting to be dimmable**
- › **Fore Deck Spa Tub installation**
- › **Removable pennant flag fitted to bell cradle structure**
- › **Valve and 2nd filling point required for the Fore Deck spa bath**
- › **Teak topped lid required for Fore Deck spa bath in three sections**
- › **Additional AC sockets - 1 x Double Exterior Socket: Flybridge port side aft -, 1 x Double Exterior Socket:- Flybridge located on the main table pedestal**
- › **Flybridge starboard side cabinet with perspex storage for exterior glassware and bottles**
- › **Flybridge - 1 x Custom double fridge drawer unit fitted in the starboard side bar**
- › **Fore Deck sail canopies fitted for the wheelhouse deck seating area and main sunpad (does not cover forward deep seats).**
- › **Aft Cockpit - Additional slide in teak leaf for table with canvas bag for when not in use.**
- › **Hand bidet showers required for all Guest En- suites and Day Head**
- › **Recess in the Master En-suite outboard upstand of shower cubicle (in stone, including stainless rail at the front of the recess) for the stowage of shower gels etc**
- › **Black water IMO discharge installed at the stern of the vessel.**
- › **All Guest cabin blinds and Dining area roman blinds to be electric operation (except en-suites). Blinds must be upgraded to incorporate quieter Sonnesse 30 premium electric motors. Blind control to be wired to Vimar and a Somfy Telis 6 RF remote control for each cabin to allow control with fine adjustment.**
- › **Dedicated copex installed from Technical area to hardtop with pull wires for future fitment by Client of Flir camera**
- › **Under bed storage - lift up bed frame with gas support. No under bed drawers fitted to maximise storage in the Master, Port & Stbd double staterooms**
- › **Two air conditioning chilled water pumps installed and valved to allow duty/standby operation.**
- › **Two raw water pumps installed and valved to allow duty/standby operation.**
- › **All cabin doors as CGI. Vertical grain to upper and lower panels and horizontal to middle panel with stainless trim detail.**
- › **TV rise and fall - Aft face feature panel to be owner supplied (decorative panel).**
- › **CCTV recording facility to be provided with NVR recorder, connected to the Tijssen IP cameras and Pepwave for remote monitoring also. Note any 3g or 4G air time agreements and subscriptions are the responsibility of the Client.**
- › **Stern capstan winches - two Lewmar C6 400 Volt 3kW three phase vertical capstans fitted port and starboard. Capstans are to have dual rotation with separate controls with additional control unit confirmed to be designed and supplied by Lewmar**
- › **Folding stainless steel sink in the Laundry Room**
- › **Main Deck Aft Cockpit mooring bollards has stainless steel stopper eyes added**
- › **Additional sound insulation applied around the underside of the spa bath motors (cabin side) to help reduce noise transfer to the master stateroom and on the underside of the deck head in the en-suite and master cabin.**
- › **Miele H6980P 900mm Oven required in lieu of standard**
- › **Miele DGM6800 Steam Microwave combination oven required in lieu of the standard microwave**
- › **Wooden flooring (Cadorin Wenge WENSP0P10) in Master Stateroom with Cormar Sensations Light Taupe inset carpet around the berth fitted from the outboard edge of the bed side tables and extending forward to incorporate the emergency escape hatch**
- › **Main Deck Saloon console units, Port & Stbd Dining console, Forward dining console unit and TV rise and fall unit has recess designed in to incorporate concealed LED rope lighting at low level.**
- › **Bidet option for Tecma toilets in Forward & Aft Guest En-suites**
- › **Custom Frigoboat MS160 fridge drawer unit required in the Galley with sea water cooling. Unit to be custom with a taller lower drawer - G63895. Drawer unit to be located in outboard unit aft of sink unit as 702 and dishwasher to be relocated forward of the sink unit.**
- › **Additional satellite decoders in the lower deck Guest Staterooms**
- › **Flybridge TV rise & fall moulding with IP rated 40" TV**
- › **Upgraded interior stone to Gold Calacatta as MYC**

## Disclaimer

ATI YACHTS provides information and details about this vessel in good faith and does not expressly or implicitly guarantee the accuracy of this information, nor does it expressly or implicitly warrant the condition of the vessel. All information and details are provided for guidance only and are not binding, and do not constitute any part of any terms and conditions. A potential buyer should instruct their agents or marine surveyors to investigate these details to verify all information. All potential buyers should be aware that the manufacturer's model year may vary from builder to builder and may not necessarily correspond to the vessel's year of construction. This vessel is offered subject to prior sale, price change, or withdrawal without notice.